

British Standard Sprockets

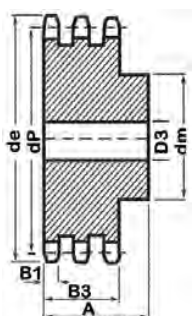

"Why compete against your supplier when you can be our partner"

08B-1-2-3 Sprocket			Teeth	de	dp	Simplex				Duplex				Triplex				
						dm	D1	A	App. Kg	dm	D2	A	App. Kg	dm	D3	A	App. Kg	
			8	38	33.18	20	10	25	0.13									
			9	42	37.13	24	10	25	0.14	24	10	32	0.18					
			10	45.9	41.1	26	10	25	0.15	28	10	32	0.22					
			11	49.9	45.07	29	10	25	0.17	32	12	35	0.24					
			12	53.9	49.07	33	10	28	0.24	35	12	35	0.26					
			13	57.9	53.06	37	10	28	0.25	38	12	35	0.28	38	16	50	0.59	
			14	61.9	57.07	41	10	28	0.31	42	12	35	0.34	42	16	50	0.72	
			15	65.9	61.09	45	10	28	0.33	46	12	35	0.36	46	16	50	0.81	
			16	69.9	65.1	50	12	28	0.37	50	16	38	0.40	50	16	50	0.90	
			17	74	69.11	52	12	28	0.51	54	16	38	0.44	54	16	50	1.04	
			18	78	73.14	56	12	28	0.54	58	16	38	0.49	58	16	50	1.22	
			19	82	77.16	60	12	28	0.65	62	16	38	0.57	62	16	50	1.41	
			20	86	81.19	64	12	28	0.76	66	16	38	0.65	66	16	50	1.58	
			21	90.1	85.22	68	14	28	0.82	70	16	40	0.72	70	16	55	1.81	
			22	94.1	89.24	70	14	28	0.88	70	16	40	0.80	70	16	55	2.03	
			23	98.1	93.27	70	14	28	1.05	70	16	40	0.83	70	16	55	2.27	
			24	102.1	97.29	70	14	28	1.07	75	16	40	0.94	75	16	55	2.44	
			25	106.2	101.3	70	14	28	1.13	80	16	40	0.98	80	16	55	2.54	
			26	110.2	105.4	70	16	30	1.15	85	16	40	1.04	85	20	55	OA	
			27	114.2	109.4	70	16	30	1.19	85	16	40	1.08	85	20	55	2.85	
			28	118.3	113.4	70	16	30	1.30	90	16	40	1.10	90	20	55	3.16	
			29	121		80	11	30	OA	OA	OA	OA	OA	95	20	55	OA	
			30	126.3	121.5	80	16	30	1.36	100	16	40	1.16	95	20	55	3.48	
			31	130.4	125.5	90	16	30	1.41									
			32	134.4	129.6	90	16	30	1.46	100	20	40	1.24					
			33	138.4	133.6	90	16	30	1.51									
			34	142.5	137.6	90	16	30	1.56	100	20	40	1.33					
			35	146.5	141.7	90	16	30	1.61									
			36	150.6	145.7	90	16	35	1.69	100	20	40	2.05					
			37	154.6	149.8	90	16	35	1.74									
			38	158.6	153.8	90	16	35	1.78	100	20	40	2.17	120	25	55	6.49	
			39	162.7	157.8	90	16	35	1.83									
			40	166.7	161.9	90	16	35	1.88	100	20	40	2.28					
			41	171						OA	OA	OA						
			42	176.5	170	90	19	35	1.97	110	20	45	2.32					
			43	179						OA	OA	OA						
			44	185						OA	OA	OA						
			45	188.6	182.1	90	19	35	2.11	110	20	45	2.49					
			46	193						OA	OA	OA						
			48	200.7	194.2	100	19	35	2.76	110	20	45	2.65					
			50	208.8	202.3	OA	OA	OA	2.90	OA	OA	OA						
			55	229	222.5	OA	OA	OA	3.15									
			57	233.1	230.5	100	19	35	3.28	110	25	45	3.88	120	25	60	12.62	
			60	249.2	242.7	100	19	35	3.45									
			76	313.9	307.3	100	19	35	5.73	120	30	45	6.60	130	30	65	22.23	
			95	390.7	384.1	100	25	35	8.90	120	30	45	9.89					
			114	467.4	460.9	100	25	35	11.17	120	30	45	12.88					

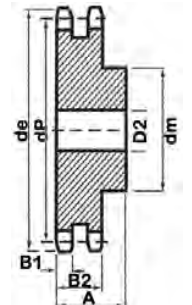
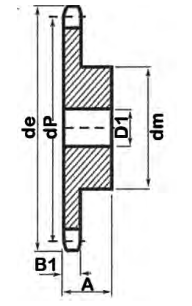
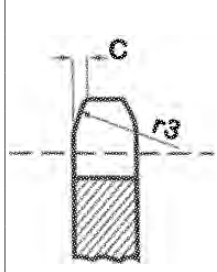

Pinions	mm
Tooth Radius r3	
Radius Width C	
Tooth Width B1	7.2
Tooth Width b1	
Tooth Width B2	21
Tooth Width B3	34.9

Chain	mm
Pitch	12.7
Inside	7.75
Roller ø	8.51